

GROUND FLOOR

TENNIS COURTS & ORCHARD

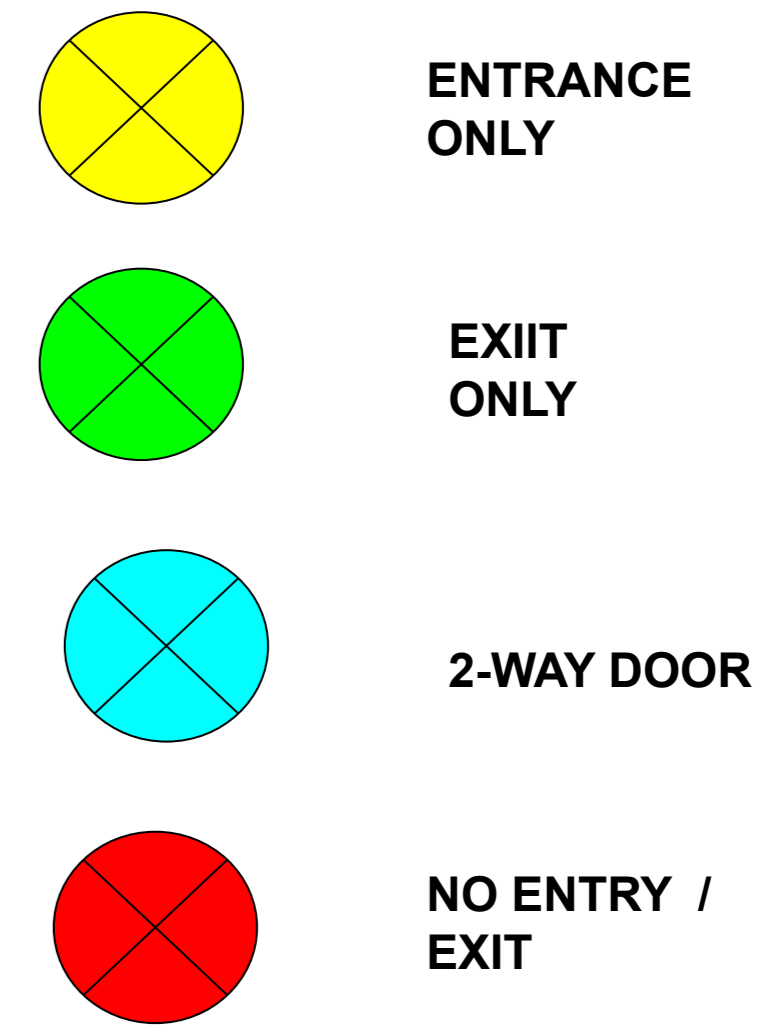
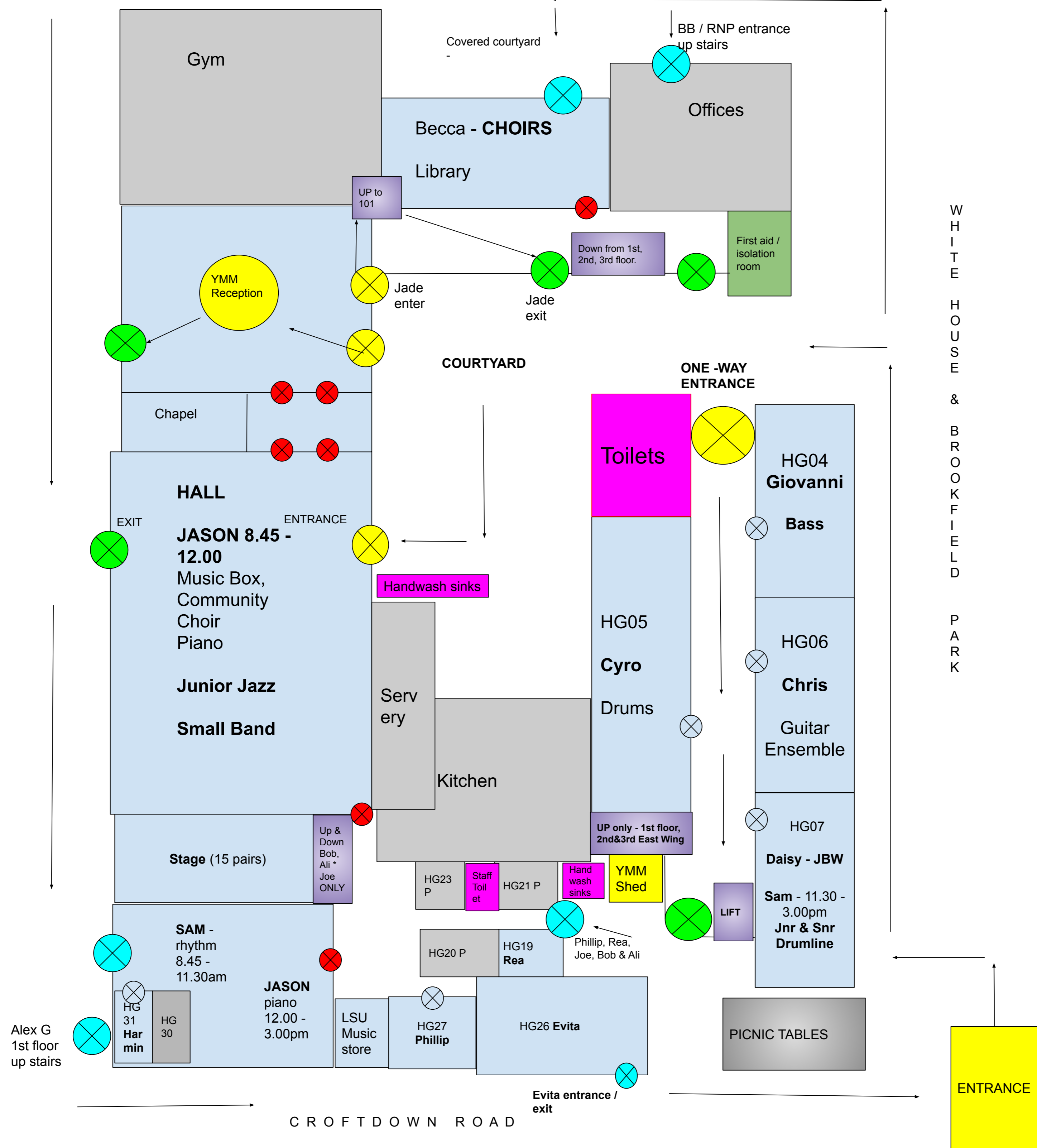

WHITE HOUSE & BROOKFIELD PARK

CROFTDOWN ROAD

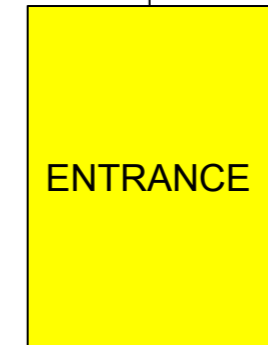

Alex G 1st floor up stairs

Evita entrance / exit

Up & Down Bob, Ali * Joe ONLY

UP only - 1st floor, 2nd&3rd East Wing

Down from 1st, 2nd, 3rd floor.

UP to 101

ONE-WAY ENTRANCE

BB / RNP entrance up stairs

Covered courtyard

COURTYARD

HALL

JASON 8.45 - 12.00
Music Box,
Community Choir
Piano

Junior Jazz
Small Band

Stage (15 pairs)

SAM - rhythm
8.45 - 11.30am

JASON piano
12.00 - 3.00pm

Handwash sinks

Serv eryl

Kitchen

Toilets

HG05
Cyro
Drums

HG04
Giovanni
Bass

HG06
Chris
Guitar Ensemble

HG07
Daisy - JBW
Sam - 11.30 - 3.00pm
Jnr & Snr Drumline

PICNIC TABLES

LIFT

YMM Shed

HG23 P

Staff Toilet

HG21 P

HG20 P

HG19 Rea

Phillip, Rea, Joe, Bob & Ali

HG23 P

HG20 P

HG27 Phillip

HG26 Evita

HG 31 Harmin

HG 30

LSU Music store

EXIT

ENTRANCE

Jade enter

Jade exit

ENTRANCE ONLY

EXIIT ONLY

2-WAY DOOR

NO ENTRY / EXIT